

SPIDER

RANGE OF SUBSOILERS



***Made in Italy
since 1957***





SPIDER

The subsoiler "SPIDER" was designed and built to meet the requirements of heavy and intense use. The characteristics of the steel used and the particular structure with bolted joints make the SPIDER suitable for all working conditions. Each shank features a shear bolt safety device and a quick-release tip, and can be equipped with the appropriate winged points. The position and distance of the shanks is customizable and can be easily changed to best fit the needs of the most demanding users.

The SPIDER subsoiler range includes several models, divided into the lines X,G,M, and S, with a variable number of shanks: from 5 to 11. The different configurations allow the SPIDER to match tractors with 70 HP up to over 600 HP.

The subsoiler can be used in standard version or equipped with the special double roller with the mechanical or hydraulic depth adjustment.



Shanks features shear bolt safety device which preserves the structure in case of obstacles.

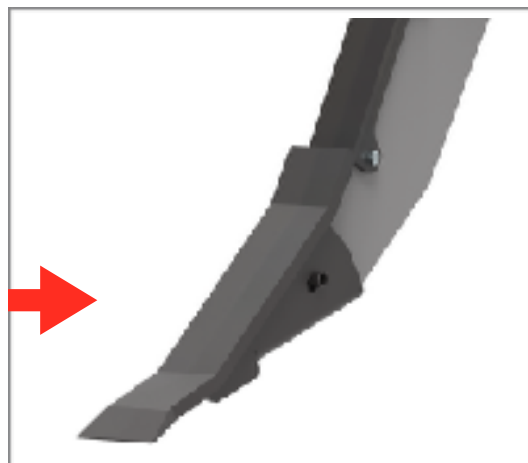

Tips are made with wear resistant steel and they are easily replaceable thanks to a quick-assembly system.

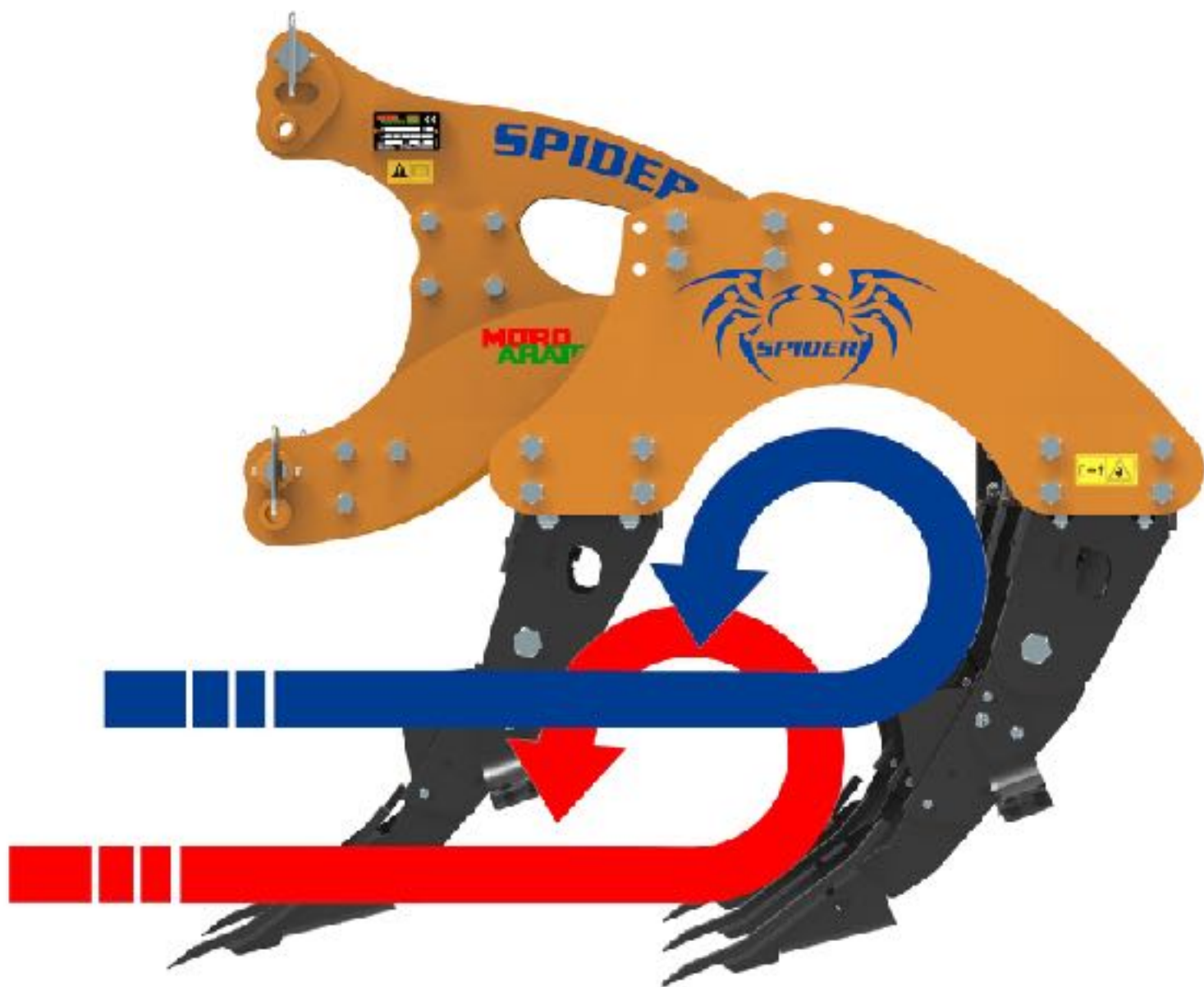

The presence of abundant crop residues is not problematic, since the considerable height from the ground and the distance between the rows of shanks ensure the free flow of the soil even while deep working. Therefore, undesired accumulations between the anchors and the structure are avoided, allowing an optimal mixture of the soil.

SPIDER X



The subsoiler SPIDER X is available in 7, 9 and 11 shank versions. The double 180° folding system allows to reduce to 2.5m the encumbrance for an easier transport. In the operating position, thanks to special safety hooks, the structure is designed to guarantee the maximum rigidity and sturdiness needed for coupling to high-power tractors and for intense and demanding use.



The “SPIDER X” can be used on its own or together with a special double “RCX” roller with hydraulic depth adjustment. The use of a front roller with a diameter of 360mm and a rear roller measuring 220mm, ensures excellent fracturing of the clods and levelling of the soil, avoiding the clogging which typically occurs with smaller diameter rollers.

To guarantee perfect coupling, the rollers’ folding system is fitted with an automatic hydraulic locking system

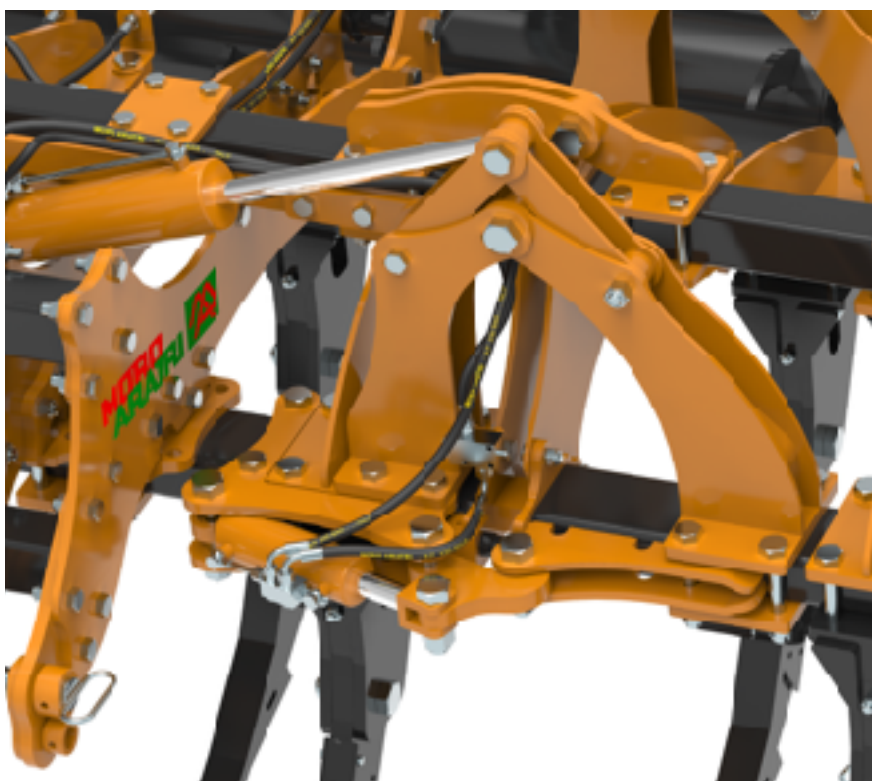

Secure coupling of the folding structure to the main structure is guaranteed by sturdy steel hooks. Activation of the locking device is completely automatic, both for opening and closure, and the special “play compensation” feature of the locking device guarantees perfect coupling in all conditions.



SPIDER X

250-600 HP

7/9/11 shanks



TECHNOLOGY



STONE SYSTEM

The subsoiler "SPIDER X Stone System", available with 9 and 11 shanks, represents the latest concept of hydraulic subsoiler for stony soils. The main structure is designed entirely with bolted joints, an absolutely innovative solution in the industry and a real challenge compared to the older, traditional concepts.

The double 180° folding system allows to reduce to 2.5m the encumbrance for an easier transport.

SPIDER X

300-600 HP

9/11 shanks

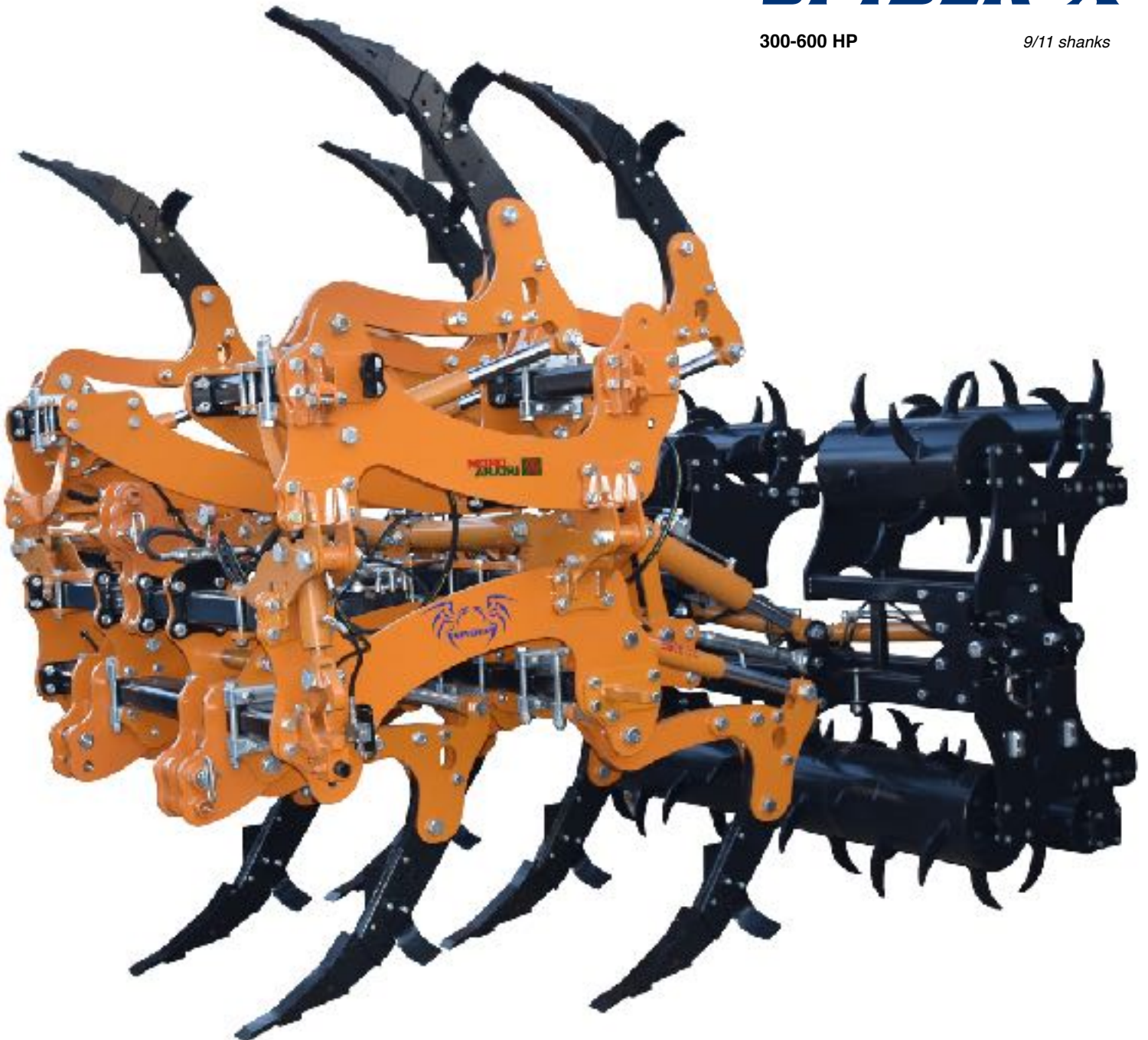

SPIDER G,M,S



The SPIDER subsoiler range includes the models G,M, and S ,with a variable number of shanks: from 5 to 9. The different configurations allow the SPIDER to match tractors with 70 HP up to over 450 HP.

The subsoiler can be used in standard version or equipped with the special double roller with the mechanical or hydraulic depth adjustment.

The G and M lines are also available with the STONE SYSTEM special technology.



SPIDER G

150-450 HP

5/7/9 shanks



SPIDER M

110-240 HP

5/7 shanks



SPIDER S

70-180 HP

5/7 shanks



TECHNOLOGY

SS STONE
SYSTEM[®]



STONE SYSTEM

The subsoiler "SPIDER Stone System", available with 5, 7 and 9 shanks, represents the latest concept of hydraulic subsoiler for stony soils. The main structure is designed entirely with bolted joints, an absolutely innovative solution in the industry and a real challenge compared to the older, traditional concepts.

Even the hydraulic circuit is state-of-the-art, with a oversized battery formed by small accumulators of high-pressure nitrogen. These accumulators have the task of storing, in the shortest possible time, the energy produced by the collision with the stones and apply it, once the obstacle is overcome, to resume its operating position.

The pressure of the hydraulic system can be adjusted to adapt to different working conditions.





The constructive solution to entrust the delicate task of safeguarding the structure to a battery of accumulators in comparison to a single accumulator, represents an important advantage in terms of reliability. The SPIDER STONE SYSTEM is able to continue to work even in case of failure of one or more accumulators.





UNIQUE

The special shank shape ensures an optimal release and movement in case of impact: the shank is quickly guided outside the soil.

Special elastic steels enables also lateral movement: The STONE SYSTEM is able to absorb all the stresses and to ensure reliability and durability.

SS STONE[®]
SYSTEM

SPIDER G

160-450 HP

5/7/9 shanks

STONE SYSTEM element simulation: the joint geometry allows an extraordinary elevation able to overcome big obstacles, maintaining the optimum shank inclination while working.

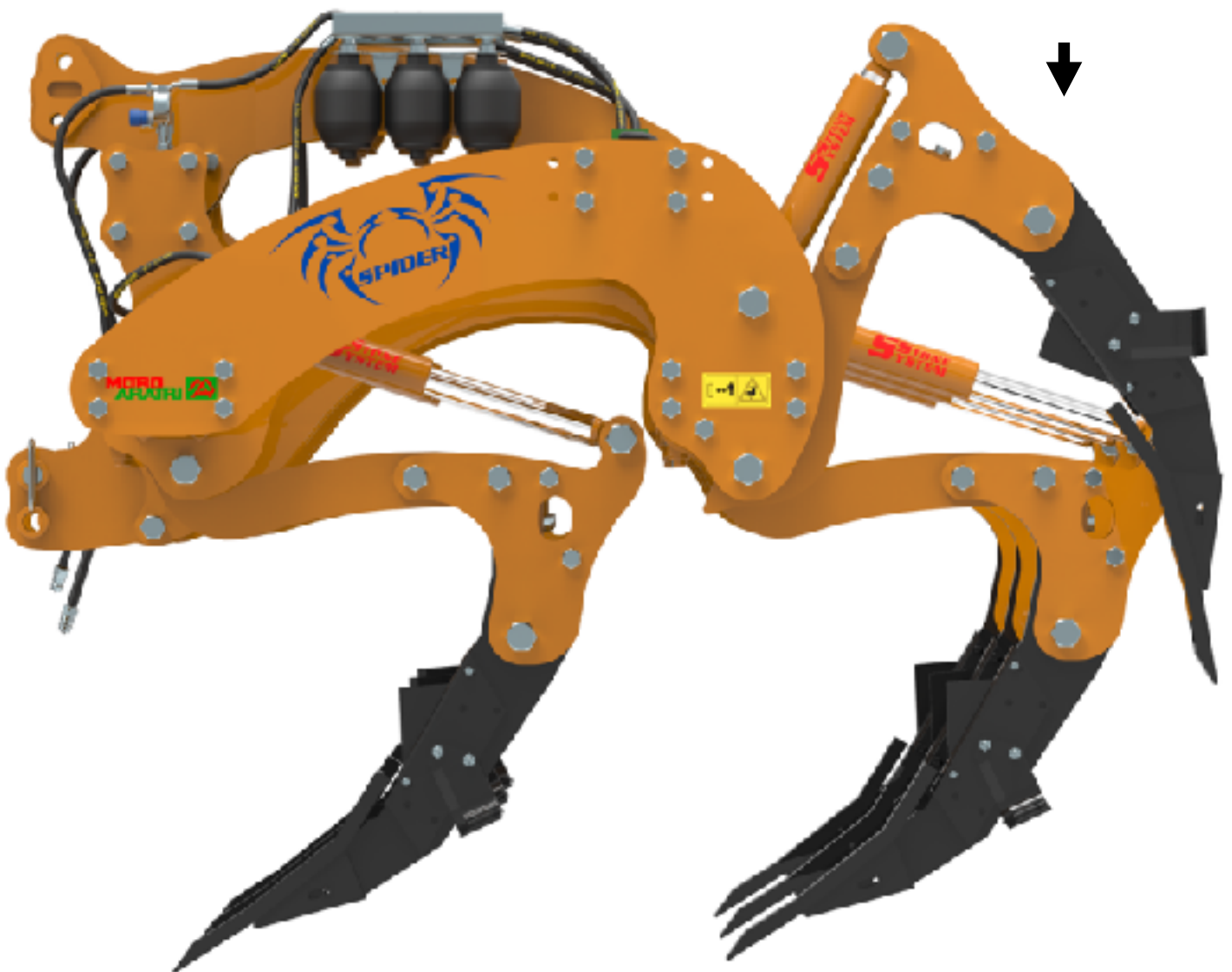

SPIDER M

90-230 HP

5/7 shanks



EQUIPMENTS



CLOD CONTAINMENT

The clod containment device, foldable to limit the transport width, is available with manual or hydraulic drive.

PATENTED

The hydraulic drive of the clod containment device is a MORO Aratri patent.



For road transport, it is possible to add the marker boards and lighting.



SPECIAL

SPIDER subsoliers come with an exclusive system for continuous variation of both the inclination and distance between the two rollers, which allows ideal adjustment to any working condition.

Rollers are equipped with an hydraulic parallelogram linkage, which ensure a quick and precise adjustment of the working depth.

Also available with the mechanical working depth adjustment.



The rollers achieve a preliminary and significant soil tillage, facilitating and reducing the following operations. In addition, the double roller particularly contributes to the mixture of crop residues.



ROLLER RX

Special roller with a diameter of 360 mm for soil crushing without clogging.



DOUBLE ROLLER

Double roller with different diameters depending on the model:

- 220 mm
- 160 mm

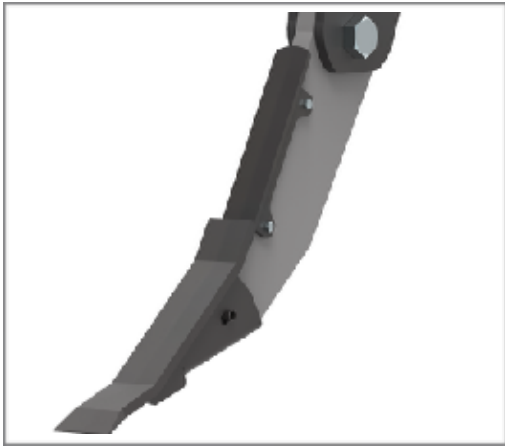

STANDARD SHANK

- Shear bolt safety device
- Wear resistant tip with quick-release device
- Wear resistant shank protection



CLOD SHATTERING SHANK

- Shear bolt safety device
- Wear resistant tip with quick-release device
- Clod shattering fins

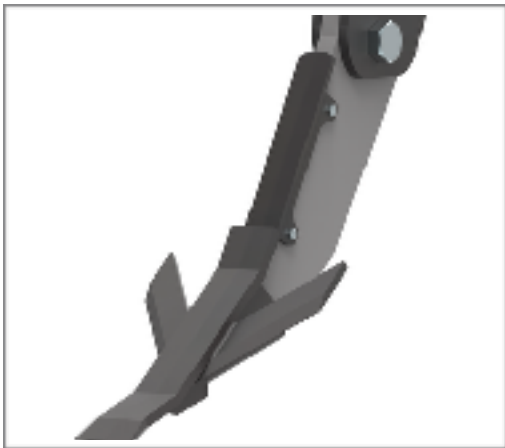

FINS SHANK

- Shear bolt safety device
- Wear resistant Fins tip with quick-release device
- Wear resistant shank protection

WORKING WHEEL Working wheel with depth adjustment is available for each model.



TECHNICAL DATA

SPX									SPIDER X	
MODEL	NUMBER OF SHANKS	WORKING WIDTH m	WORKING DEPTH cm	TRANSPORT WIDTH m	ROW SPACING FRONT-REAR cm	UNDERBEAM CLEARANCE cm	WEIGHT kg	with ROLLERS kg	POWER HP	MAX *
SPIDER 11X	5+6	4,90	60	2,5	87	92	3100	4250	320-550	600
SPIDER 9X	4+5	4,00	60	2,5	87	92	2750	3870	300-500	550
SPIDER 7X	3+4	3,10	60	2,5	87	92	2450	3550	250-400	480

SPG									SPIDER G	
MODEL	NUMBER OF SHANKS	WORKING WIDTH m	WORKING DEPTH cm	TRANSPORT WIDTH m	ROW SPACING FRONT-REAR cm	UNDERBEAM CLEARANCE cm	WEIGHT kg	with ROLLERS kg	POWER HP	MAX *
SPIDER 9G-400	4+5	4,00	65	3,9	87	92	2100	2900	250-400	450
SPIDER 7G-400	3+4	4,00	65	3,9	87	92	1740	2540	200-370	400
SPIDER 7G-300	3+4	3,10	65	3	87	92	1700	2400	190-370	400
SPIDER 5G-300	2+3	3,10	65	3	87	92	1440	2140	150-250	280
SPIDER 5G-250	2+3	2,75	65	2,5	87	92	1400	2040	150-250	280

SPM									SPIDER M	
MODEL	NUMBER OF SHANKS	WORKING WIDTH m	WORKING DEPTH cm	TRANSPORT WIDTH m	ROW SPACING FRONT-REAR cm	UNDERBEAM CLEARANCE cm	WEIGHT kg	with ROLLERS kg	POWER HP	MAX *
SPIDER 7M-300	3+4	3,00	55	3	80	78	1170	1670	130-220	240
SPIDER 7M-250	3+4	2,55	55	2,5	80	78	1150	1600	130-220	240
SPIDER 5M-300	2+3	3,20	55	3	80	78	980	1480	110-170	200
SPIDER 5M-250	2+3	2,60	55	2,5	80	78	940	1390	110-170	200

SPS									SPIDER S	
MODEL	NUMBER OF SHANKS	WORKING WIDTH m	WORKING DEPTH cm	TRANSPORT WIDTH m	ROW SPACING FRONT-REAR cm	UNDERBEAM CLEARANCE cm	WEIGHT kg	with ROLLERS kg	POWER HP	MAX *
SPIDER 7S-300	3+4	3,00	50	3	75	71	850	1250	100-160	180
SPIDER 7S-250	3+4	2,55	50	2,5	75	71	830	1200	100-160	180
SPIDER 5S-250	2+3	2,65	50	2,5	75	71	690	1060	70-120	140
SPIDER 5S-200	2+3	2,00	50	2,0	75	71	670	1000	70-120	140



SPX Stone									SPIDER X	
MODEL	NUMBER OF SHANKS	WORKING WIDTH m	WORKING DEPTH cm	TRANSPORT WIDTH m	ROW SPACING FRONT-REAR cm	UNDERBEAM CLEARANCE cm	WEIGHT kg	with ROLLERS kg	POWER HP	MAX *
SPIDER 11X Stone	5+6	4,90	60	2,5	100	100	2950	4300	320-550	600
SPIDER 9X Stone	4+5	4,00	60	2,5	100	100	2600	3980	300-500	550

SPG Stone									SPIDER G	
MODEL	NUMBER OF SHANKS	WORKING WIDTH m	WORKING DEPTH cm	TRANSPORT WIDTH m	ROW SPACING FRONT-REAR cm	UNDERBEAM CLEARANCE cm	WEIGHT kg	with ROLLERS kg	POWER HP	MAX *
SPIDER 9G Stone	4+5	4,00	60	4	100	100	2280	3050	250-400	450
SPIDER 7G-400 Stone	3+4	4,00	60	3,9	100	100	1840	2600	210-370	400
SPIDER 7G-300 Stone	3+4	3,10	60	3	100	100	1800	2450	210-370	400
SPIDER 5G-300 Stone	2+3	3,10	60	3	100	100	1490	2180	160-250	280
SPIDER 5G-250 Stone	2+3	2,75	60	2,5	100	100	1450	2050	160-250	280

SPM Stone									SPIDER M	
MODEL	NUMBER OF SHANKS	WORKING WIDTH m	WORKING DEPTH cm	TRANSPORT WIDTH m	ROW SPACING FRONT-REAR cm	UNDERBEAM CLEARANCE cm	WEIGHT kg	with ROLLERS kg	POWER HP	MAX *
SPIDER 7M Stone	3+4	3,00	50	3	85	87	1100	1690	110-200	230
SPIDER 5M-300 Stone	2+3	3,20	50	3	85	87	840	1380	90-180	200
SPIDER 5M-250 Stone	2+3	2,60	50	2,5	85	87	800	1340	90-180	200



The data indicated in this folder are approximate. The models described here can be subjected to modifications without any notice by the manufacturer. The drawings and photos may refer to equipment that is either optional or intended for other countries. Please apply to our Sales Network for any further information.

MORO Aratri s.r.l.

Via Gentile, 209 - 24056 Fontanella (BG)
-Italy-

www.moroaratri.com
mail@moroaratri.com

Telefono: +39 0363 997766
Fax: +39 0363 907168

